

Building a new home?



BEFORE

- Total floor area = 287m²
- Minimal solar access from the north means total reliance on costly heating in winter.
- Western orientation will increase exposure to hot summer afternoon sun therefore increasing the need for air-conditioning
- Covered areas will be hot in summer and cold in winter due to western orientation
- Excessive hallway space
- Relies largely on costly heating and cooling to remain comfortable
- As the cost of electricity and gas continues to rise, the value of the property will potentially diminish when compared with 'greener' houses

Not all designs are created equal

This Geolyse Design
SAVED \$12,000!

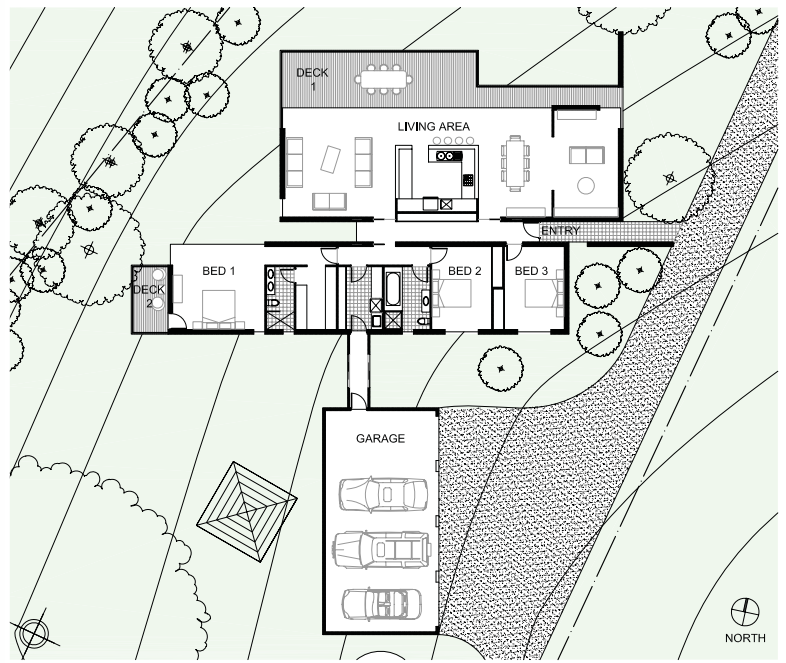

AFTER

- Total floor area = 295m²
- Northern orientation to entire living area, bedroom 1 and deck will help warm the house in winter and cool the house in summer
- Solar access to living area means lower heating costs in winter
- Minimal windows to the west will reduce cooling requirements through Summer
- Long narrow layout will help with cross ventilation reducing reliance on air conditioning
- More space is dedicated to important living areas
- Environmental initiatives will ensure the house is comfortable to live in and cheaper to run for years to come
- Contemporary design will help maintain the value of the property into the future.

This real life example demonstrates the benefits of engaging experienced professionals to design your new home.



GEOLYSE

- Civil and Environmental Engineers • Surveyors
- Environmental Consultants • Town Planners • Architects

Contact the Geolyse Architecture team
for an obligation free quote

6393 5000